

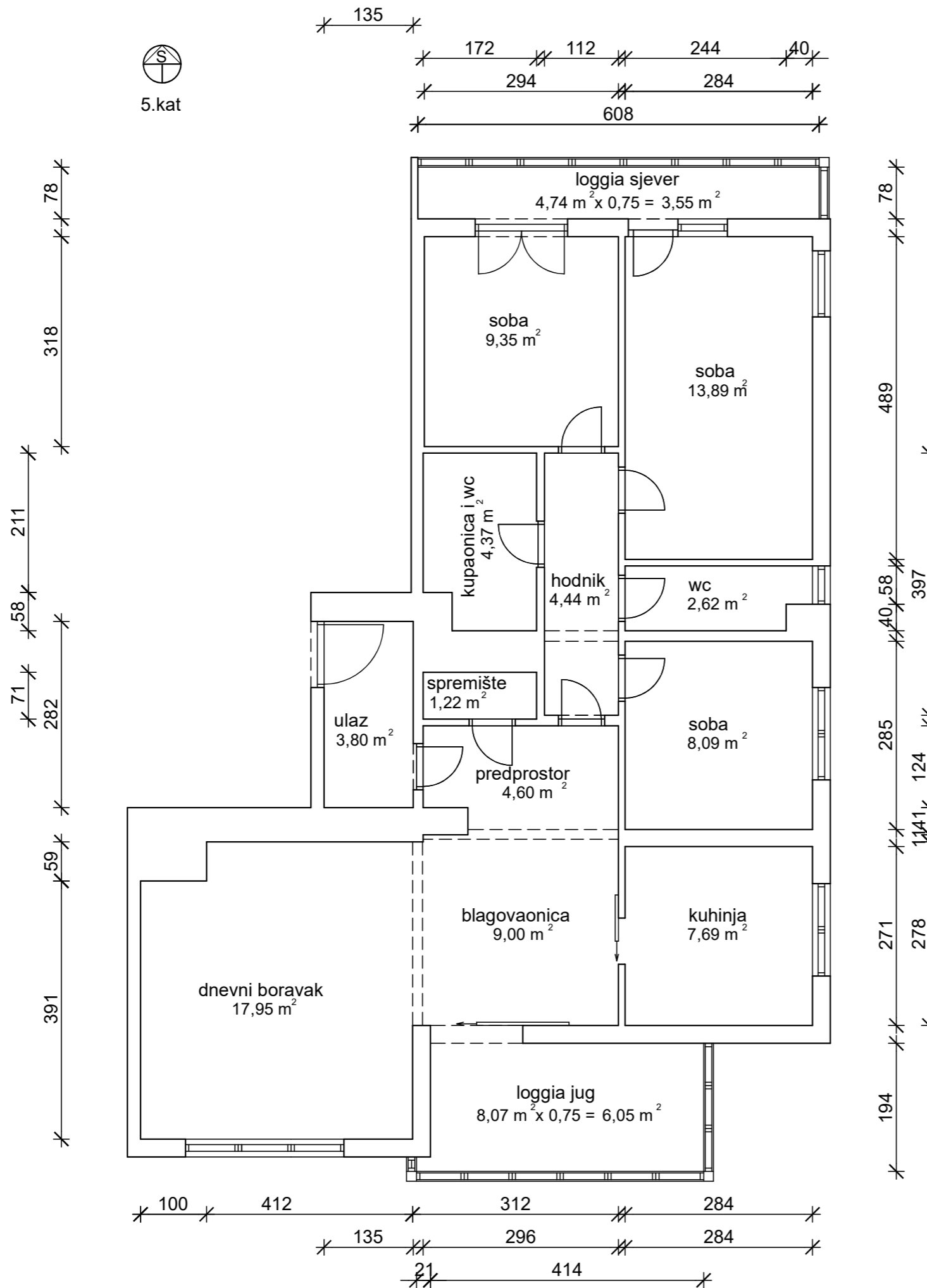

5.kat



1. ulaz	$3,80 \text{ m}^2$
2. predprostor	$4,60 \text{ m}^2$
3. spremište	$1,22 \text{ m}^2$
4. dnevni boravak	$17,95 \text{ m}^2$
5. blagovaonica	$9,00 \text{ m}^2$
6. kuhinja	$7,69 \text{ m}^2$
7. soba	$8,09 \text{ m}^2$
8. hodnik	$4,44 \text{ m}^2$
9. wc	$2,62 \text{ m}^2$
10. soba	$13,89 \text{ m}^2$
11. kupaonica i wc	$4,37 \text{ m}^2$
12. soba	$9,35 \text{ m}^2$
13. loggia jug	$6,05 \text{ m}^2$
14. loggia sjever	$3,55 \text{ m}^2$

ukupno KP	$96,62 \text{ m}^2$
ukupno NP	$99,83 \text{ m}^2$